

**DETAIL ON 'A'**  
**SCALE 1 : 2.5**

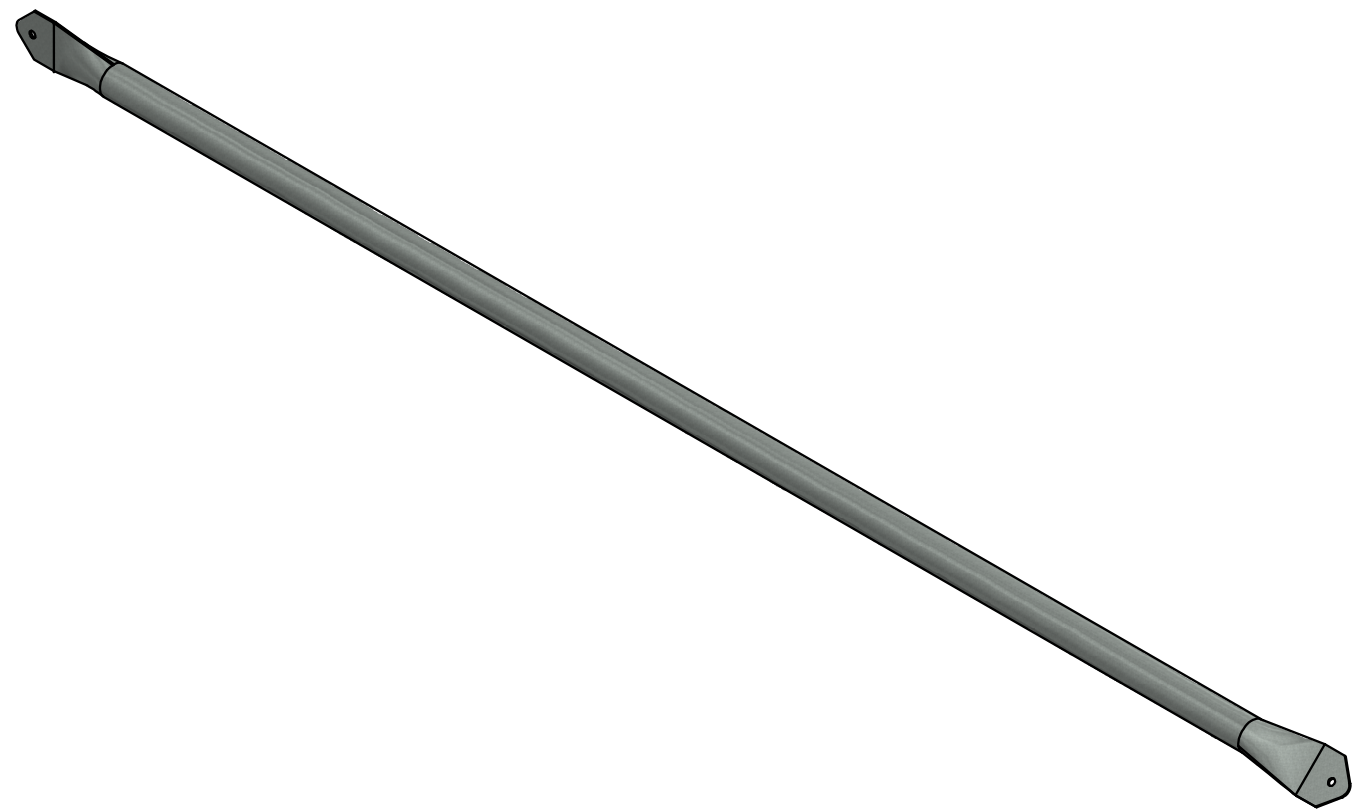

RIGHT HAND SHOWN

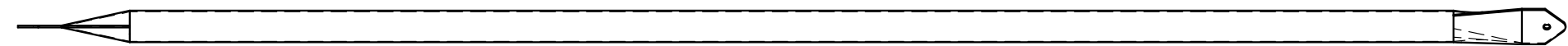

A

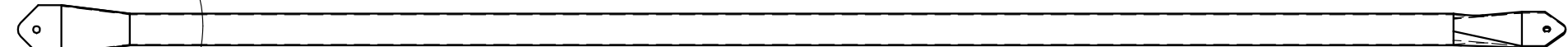
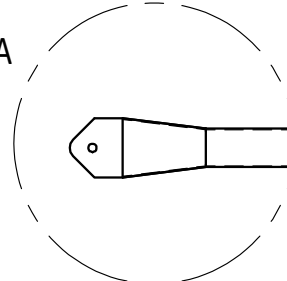

LEFT HAND SHOWN

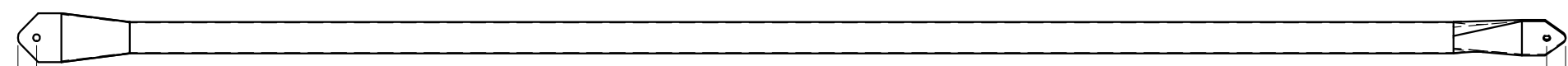
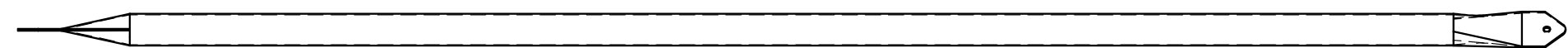

2430 HOLE TO HOLE

2490

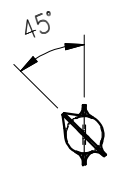
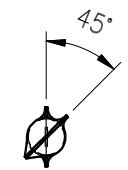

REV A - 05.08.19 - TC - Hole to Hole changed from 2420 to 2430mm

<b>MANUFACTURING INFORMATION</b> THE FOLLOWING NOTES APPLY TO ALL MANUFACTURING DRAWINGS & ANY DEVIATION FROM THESE NOTES MAY RESULT IN THE MANUFACTURED ITEM(S) BEING REJECTED <small>1. MANUFACTURER IS TO ENSURE THAT ANY FABRICATIONS ARE PRODUCED TRUE &amp; SQUARE TO GOOD ENGINEERING PRACTICE - PRIOR TO ANY MACHINING          2. ALL FABRICATION DIMENSIONS, I.E. UN-MACHINED MATERIAL SIZES ARE TO BE WITHIN A LIMIT OF 2.5mm (PRIOR TO W/C). THIS IS NOT AN ACCUMULATIVE TOLERANCE AND ANY OVERALL DIMENSIONS ARE TO BE WITHIN ±3.00mm          3. ALL DIMENSIONS TO MACHINED SURFACES, HOLE CENTRES &amp; SLOTS ETC ARE TO BE WITHIN LIMITS SHOWN IN GENERAL TOLERANCE BOX, U.O.S.          4. ALL HOLES &amp; SLOTS ARE TO BE MACHINED TO LIMITS SHOWN IN GENERAL TOLERANCE BOX, TO BE SQUARE &amp; PARALLEL TO DATUM MACHINED FACE          5. ALL MACHINED FACES ARE TO BE SQUARE TO WITHIN ±0.25° U.O.S.          6. ALL MACHINED FACES ARE TO BE PARALLEL TO WITHIN ±0.025mm U.O.S.          7. ALL BORES &amp; DIAMETERS ARE TO BE CONCENTRIC TO WITHIN ±0.05mm U.O.S.</small>		<b>GENERAL TOLERANCES ONLY TO MACHINED SURFACE</b> <table border="1"> <tr> <th>DIMENSIONS SHOWN</th> <th>TOLERANCE</th> <th>DIMENSIONS SHOWN</th> <th>TOLERANCE</th> </tr> <tr> <td>X</td> <td>±1.00mm</td> <td>X,XX</td> <td>±0.25mm</td> </tr> <tr> <td>X.X</td> <td>±0.50mm</td> <td>X,XXX</td> <td>±0.13mm</td> </tr> </table>		DIMENSIONS SHOWN	TOLERANCE	DIMENSIONS SHOWN	TOLERANCE	X	±1.00mm	X,XX	±0.25mm	X.X	±0.50mm	X,XXX	±0.13mm	<b>MATERIAL MILD STEEL</b> <b>SURFACE FINISH SELF-COLOR</b> <b>OVERALL MASS 4.542 kg</b>		THIS DRAWING AND THE INFORMATION CONTAINED THEREON IS THE EXCLUSIVE PROPERTY OF NP STRUCTURES LTD. IT MUST NOT BE COPIED, OR USED WITHOUT THE PRIOR WRITTEN CONSENT OF NP STRUCTURES, EXCEPT WHERE SUCH INFORMATION WAS SUPPLIED TO NP STRUCTURES LTD BY THE CLIENT TO WHOM THE DRAWING IS SUPPLIED.  <b>northern polytunnels</b> built to last MILL GREEN, WATERSIDE ROAD, COLNE, LANCASHIRE. BB8 0TA tel: +44 (0) 1282 873120 fax: +44 (0) 1282 871733 email: info@npstructures.co.uk web: www.npstructures.co.uk		<b>DO NOT SCALE IF IN DOUBT ASK</b> THIS DRAWING HAS BEEN DRAWN TO THIRD ANGLE PROJECTION 		PRODUCT CODE DBB250 FIRST USED SIMILAR TO DRAWN BY MJW DATE DRAWN 07/03/2018 SCALE @ SIZE 1:10 @ A3		DRAWING TITLE DIAGONAL BRACE BAR CORNER ANGLED (HANCED PAIR) IDENTIFICATION NUMBER DBB250 REV A	
DIMENSIONS SHOWN	TOLERANCE	DIMENSIONS SHOWN	TOLERANCE																						
X	±1.00mm	X,XX	±0.25mm																						
X.X	±0.50mm	X,XXX	±0.13mm																						